

I-640

Mill inside shoulder 1-1/4" to remove rumble strip; overlay inside shoulder with 1-1/4" D-mix. Shift traffic toward inside shoulder, lanes may be reduced to 11 foot wide; maintain 3 lanes of traffic. Begin lane widening, shoulder reconstruction to full depth traffic lane, and construction of Retaining Wall 1 from beginning of project up to Sta. 133+20±. Rebuild I-640 existing shoulder to full-depth 12 foot traffic lane from Sta. 135+50 to Sta. 139+40 (existing bridge over S.R. 33). Begin construction of bridge widening over S.R. 33 (Broadway). Construct widening on I-640 from Sta. 151+75 to Sta. 163+50 (Ramp 3).

Dutch Valley

Construct realigned Dutch Valley Road. See MOT Sheet 21B-1 for the detailed phasing of construction.

Old Broadway

Construct curb and gutter and sidewalk from Sta. 501+10 to Sta. 503+28 left. Constructed curb and gutter and sidewalk from Sta. 505+05 to the intersection with Dutch Valley Road (to be constructed in the third phase of Dutch Valley construction).

Ramp 1

Construct temporary widening to the left side of Ramp 1 from Sta. 11+80± to Sta. 15+00±. See sheet 21-B for typical section.

Addison Drive

Construct Addison Drive. Construct retaining wall 8 between Ramp 2 and Addison Drive. Maintain traffic on Truan Road. Short term closures and one-lane traffic for installation of drainage structures and tie-ins may be allowed with approval from TDOT and City of Knoxville. Signed detour routes for Greenway Drive to Truan/Addison Drive can be Mint Road, Ena Road, and/or Nora Road. Signed detour routes for Addison/Truan Drive to Greenway shall be Nora Road. All proposed closure and detour routes shall be approved by TDOT and the City of Knoxville.

Ramp 3

Construct Ramp 3 from Sta. 3+20 to Sta. 14+20, and construct Retaining Wall 9. Construct widening of box culvert at White's Creek.

S.R. 33 (Broadway)

Maintain two lanes of traffic in each direction at all times. Shift NB and SB traffic to the outside, and remove existing median from Sta. 15+15 to Sta. 15+80, and from Sta. 16+37 to Sta. 31+73. Construct median pavement widening and temporary pavement across middle of median. See sheet 21-B for typical section detail.

Relocated Old Broadway

Construct diversion channel for creek. Construct box culvert at Sta. 7+88.

TYPE	YEAR	PROJECT NO.	SHEET NO.
R.O.W.	2014	NH-I-640-7(161)	21-A
CONST.	2016	NH-I-640-7(161)	21-A

KNOX CO.
47008-3150-44 (CONST.)

I-640

REV. 01-15-16; REVISED PHASING NOTES

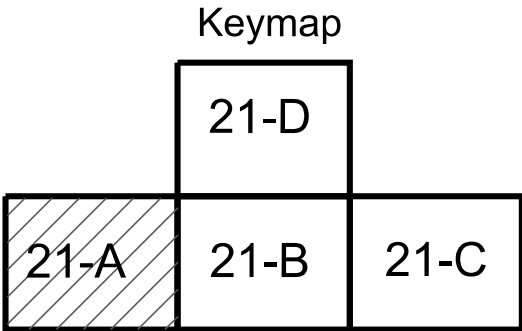
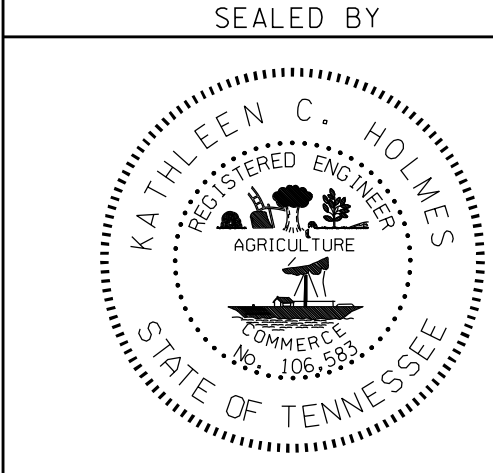
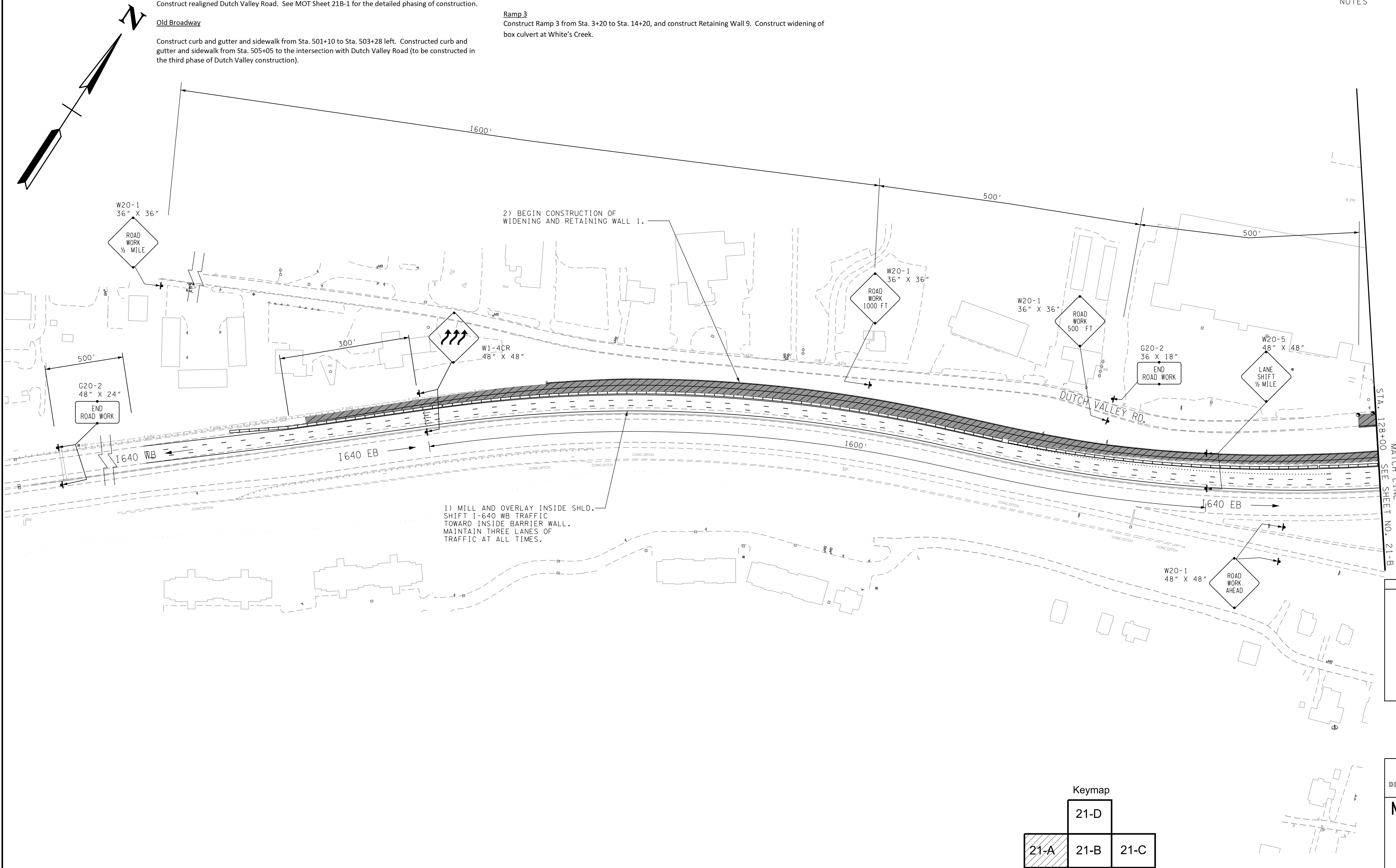

STATE OF TENNESSEE
DEPARTMENT OF TRANSPORTATION

MAINTENANCE
OF TRAFFIC
PHASE 1

SCALE: 1"= 100'